



ARMORMAN 4x4

1300 3075 43

Sales@armorman4x4.com.au
www.armorman4x4.com.au

BUSHMASTER BULL BAR FOR RANGER T9 & FORD NEXT EVEREST



**READ THE INSTALLATION INSTRUCTIONS CAREFULLY TO AVOID
DAMAGING THE VEHICLE OR THE COMPETITIVE BAR!!!**



(PLEASE CHECK THAT THE ACCESSORIES ARE COMPLETE)

COMPETITIVE BARS AND ACCESSORIES

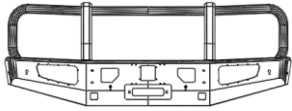

1x ATHLETIC BAR

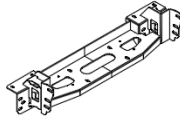

1x WINCH BRACKET

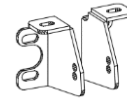

2X BRACKET A

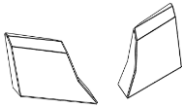

2x BAR EYEBROWS A

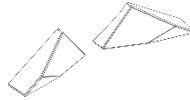

2x BAR EYEBROWS B

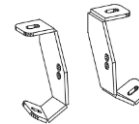

2X BRACKET B

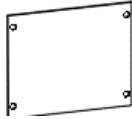

2x ACRYLIC PLATE

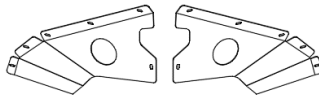

2x BIPLANE GUARD

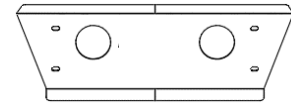

1x LOWER GUARD

LIGHTS AND OTHER ACCESSORIES



2x LAMP CASE



2x HEADLIGHTS



2x LED LIGHTS

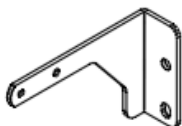

2x WATER TANK STAND



1x WATER TANK



2x LIGHT STAND

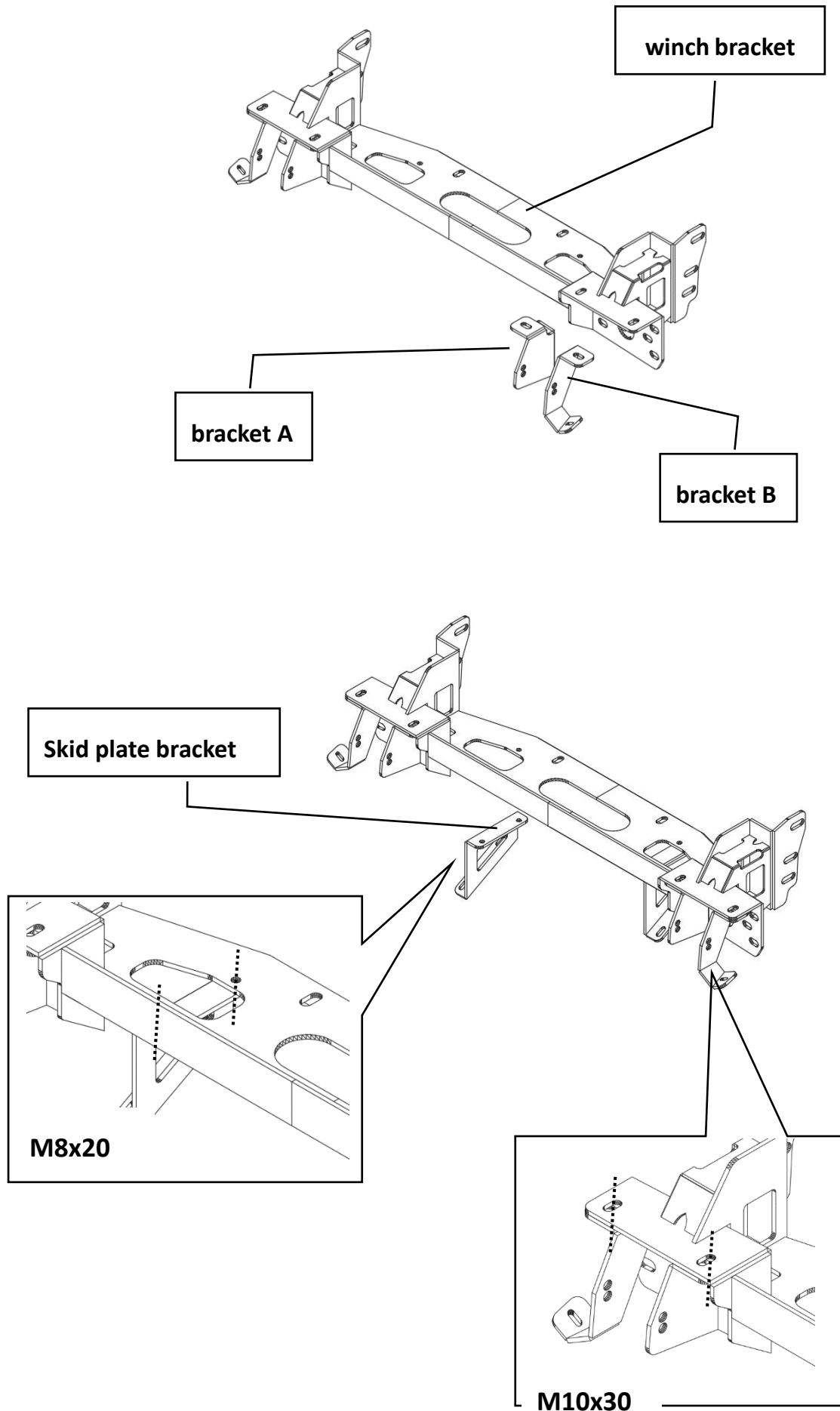



ARMORMAN 4x4

1300 3075 43

Sales@armorman4x4.com.au
www.armorman4x4.com.au

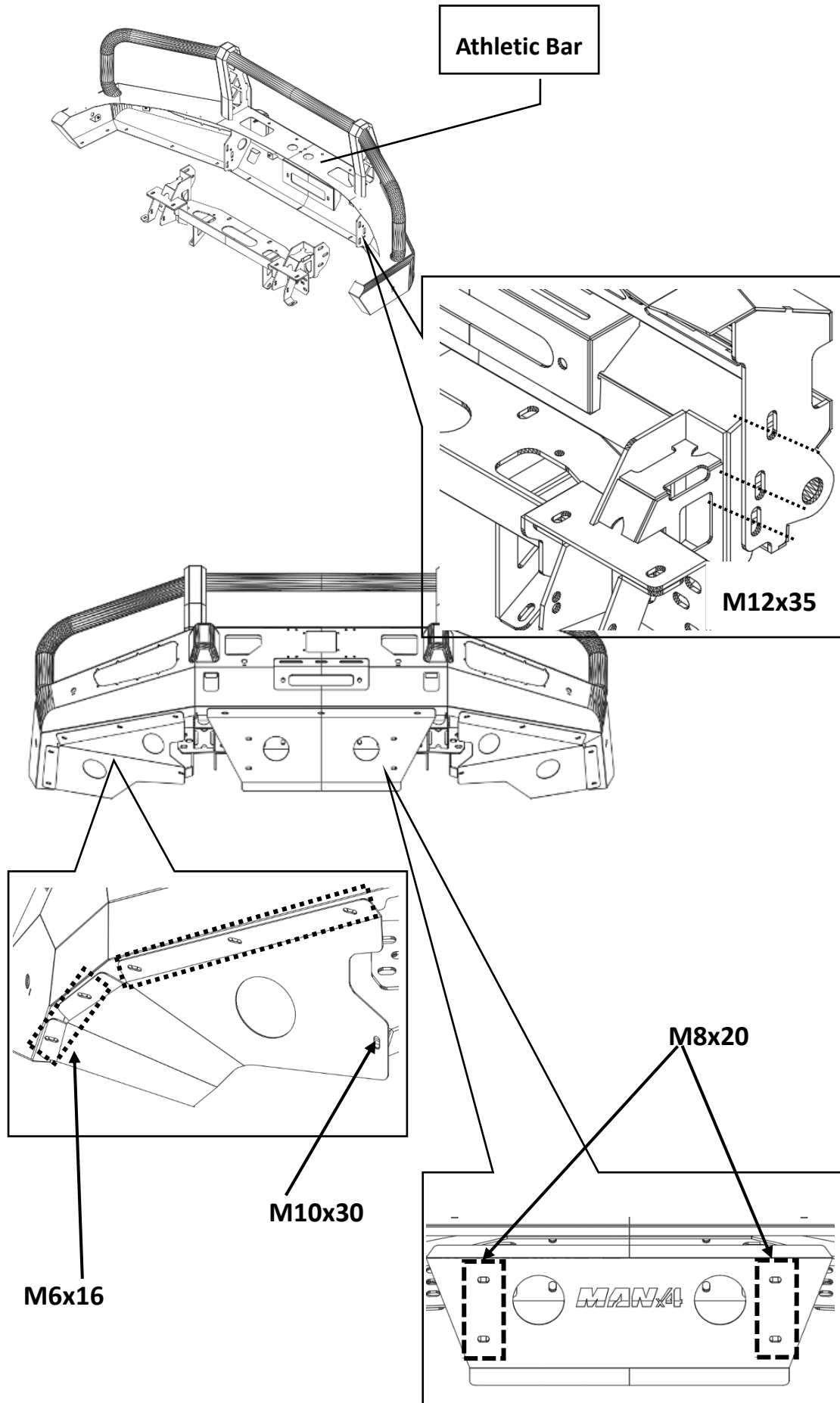

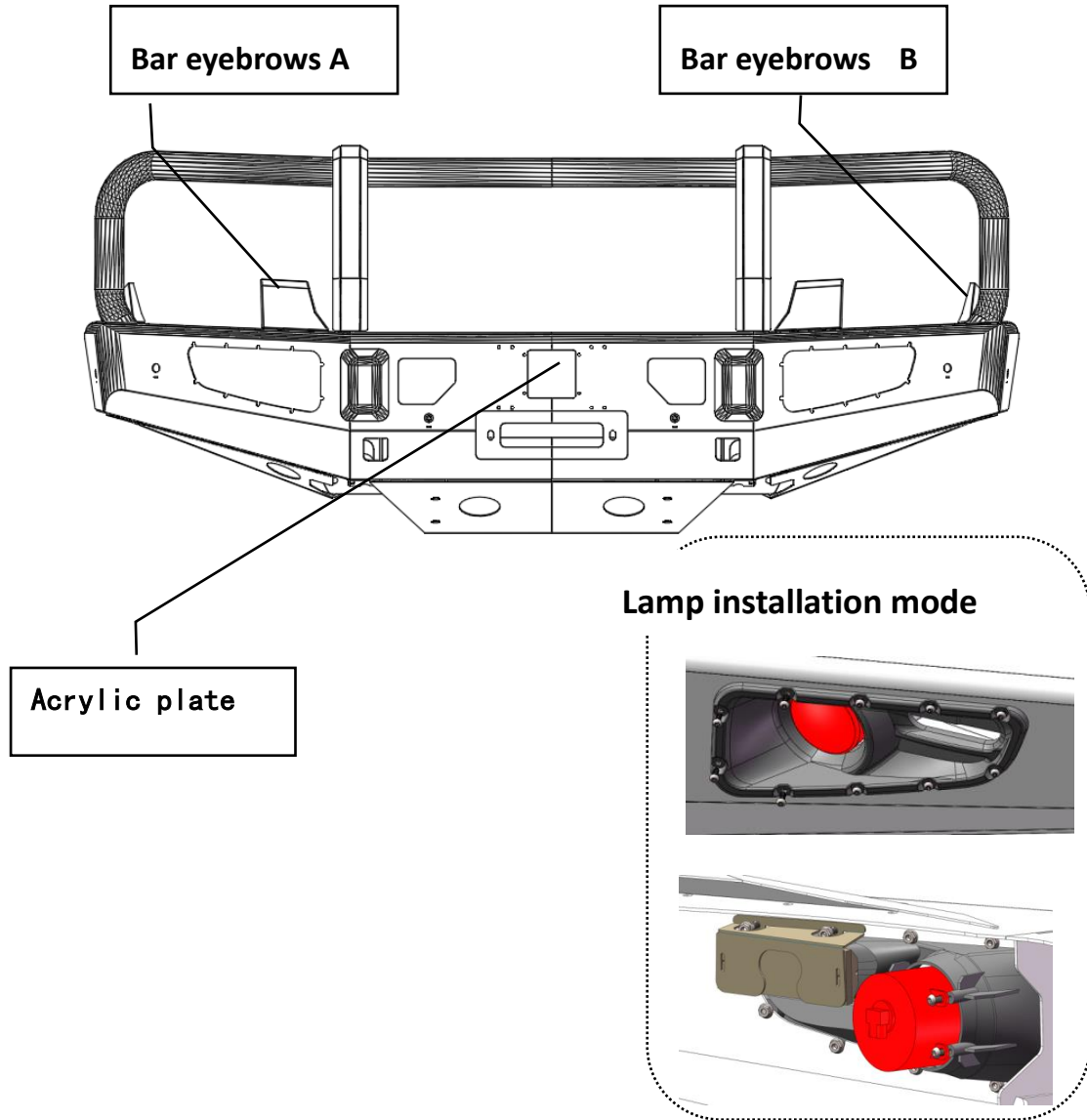



2. DO THE WIRING BASED ON BELLOW WIRING DIAGRAM

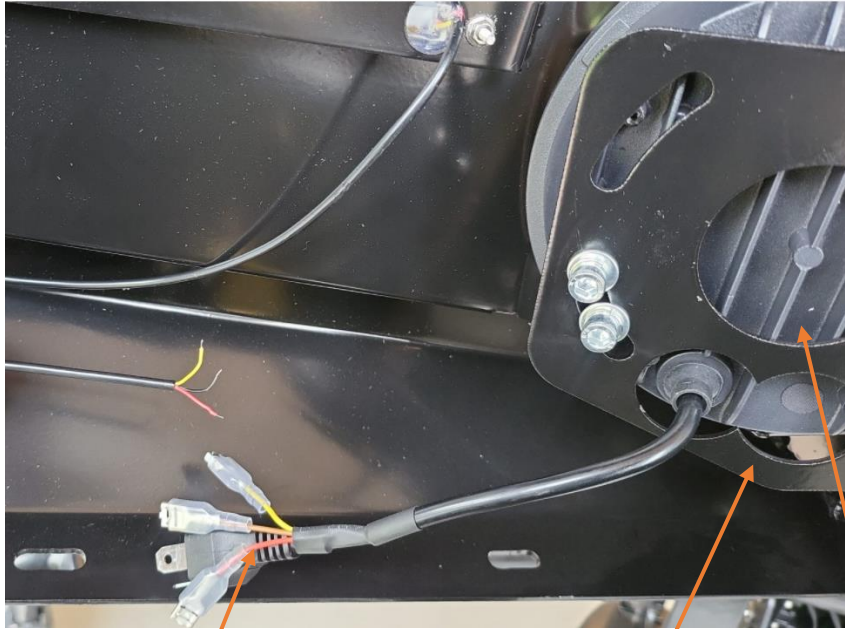

- Red: Park light
- Yellow: Indicator
- Brown Helmet
- Black: Negative

Fog light Bracket

Fog light

DRL WIRE

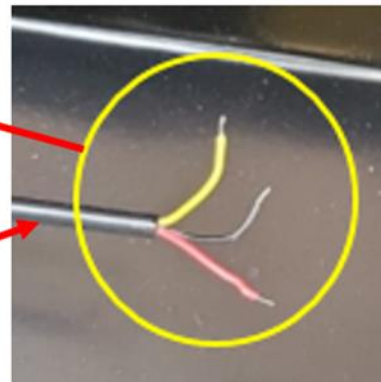



1. White: Spot light
2. Green: Fog Light
3. Red: Park
4. Black : Ground
5. Yellow: Indicator
6. Brown: Helmet

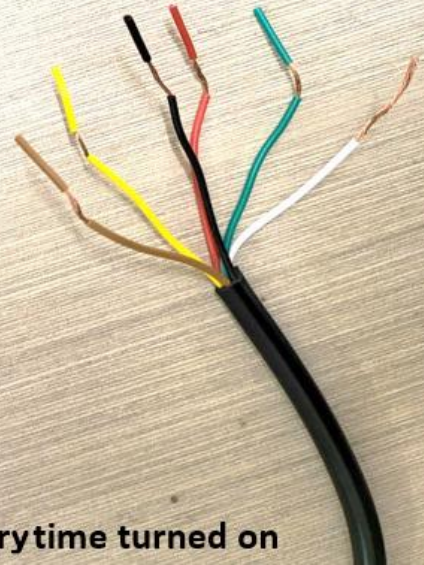

Note: The helmet keeps changing colour everytime turned on

3. FITTING FOG LIGHTS

Use the supplied left and right brackets for fitting the fog lights

Make sure the Fog light to be centered and the ARMORMAN

Writing faced up





ARMORMAN 4x4

1300 3075 43

Sales@armorman4x4.com.au
www.armorman4x4.com.au

LIGHTS

